



# Slab construction details

## Frostwall exterior insulated

Insulation under slab *if required*:  
at least 2" XPS (solid-core) foam  
(for unheated slabs), or 2 1/2" XPS  
for heated slabs<sup>1</sup>.

Unheated slabs below the frost  
line do not *require* insulation by  
Code.

Vapour barrier must  
enclose the slab, and  
ultimately be sealed to  
wall vapour barrier<sup>2</sup>.

 Slab concrete *cannot* directly  
contact frost wall material.  
The slab and the frost wall  
**must be separated with a bond  
break**. Vapour barrier will perform  
this function, as will foam<sup>3</sup>.

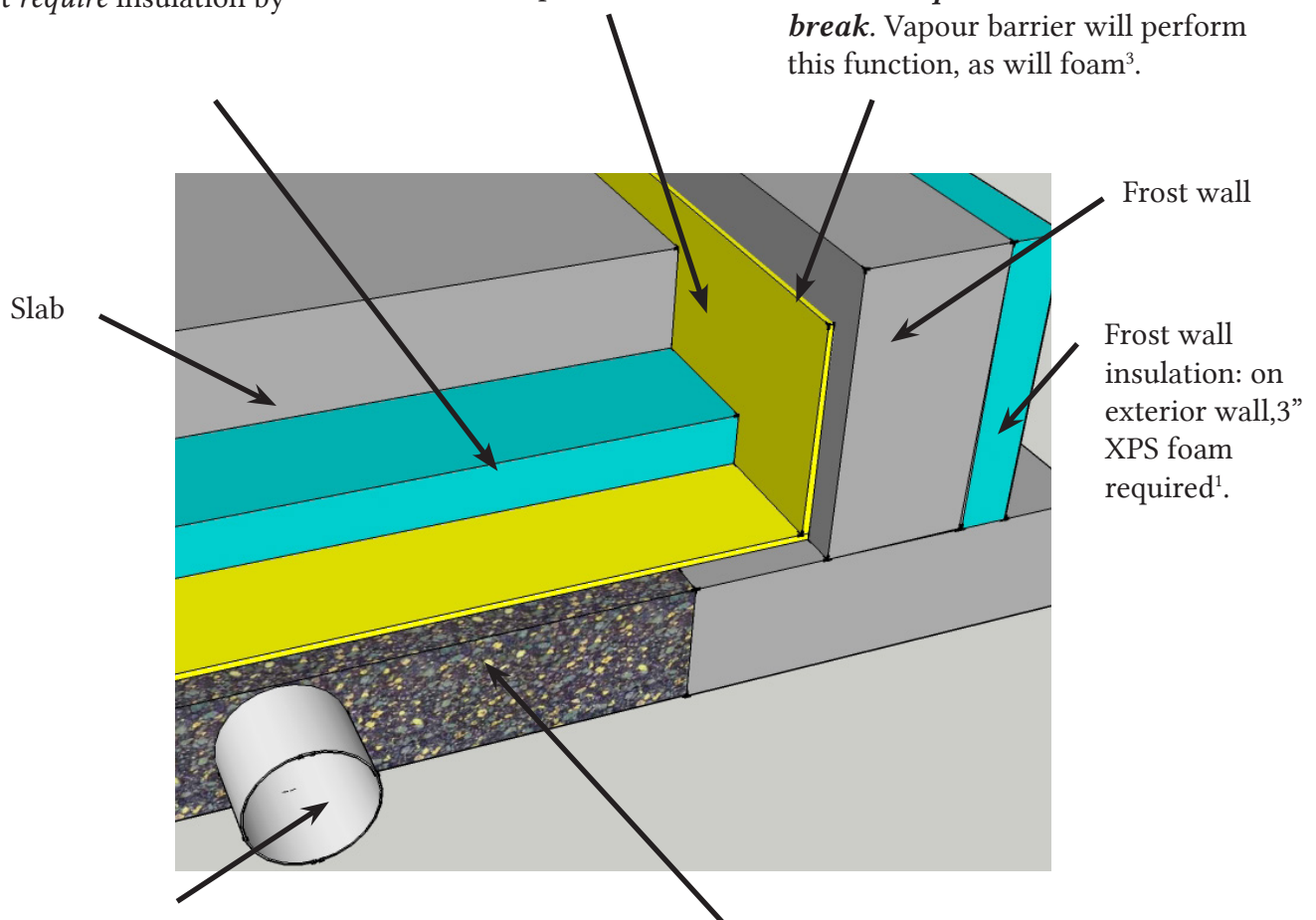

Radon pipe (Residential construction  
only). A 4" (10cm) pipe that pene-  
trates into the coarse, granular base  
material. The pipe must come up  
through the slab, and be sealed at the  
vapour barrier<sup>4</sup>.

10 cm (4") of Coarse granular fill.

 Sand and pit-run gravel are **NOT permitted**  
for the 10cm (4") fill layer under a slab. No  
more than 10 per cent of the material can be  
less than 3/8" (4.5mm) in diameter<sup>5</sup>.

Code (2015) references: [1] Table 9.36.2.8-A or 9.36.2.8-B. [2] 9.25.3.3(3) XPS foam ok as air barrier, as long as vapour barrier sealed to it or overlapped.  
[3] 9.16.4.4 [4] 9.13.4.3 [5] 9.16.2.1