

# Correct window installation procedure

Initial preparation: Cut the housewrap using an “X” in the window opening. Trim the housewrap on the bottom and sides by tucking into the window framing. Lift the housewrap at the top back up over itself and place it there temporarily.

1

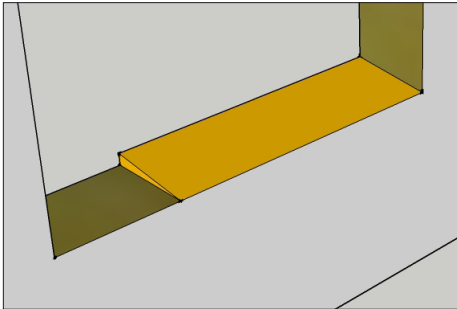

Create a six-degree slope at the base. (Install clapboard, cut a slope on a table saw, or install base wood at an angle.)

2

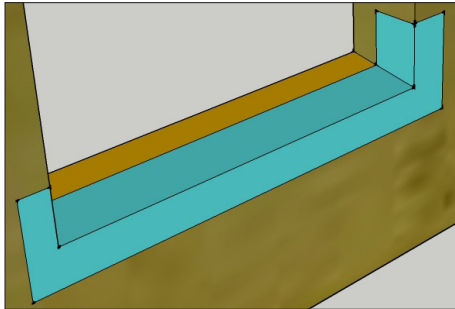

Install a flexible flashing membrane. It must lap up the side at least six inches.

3

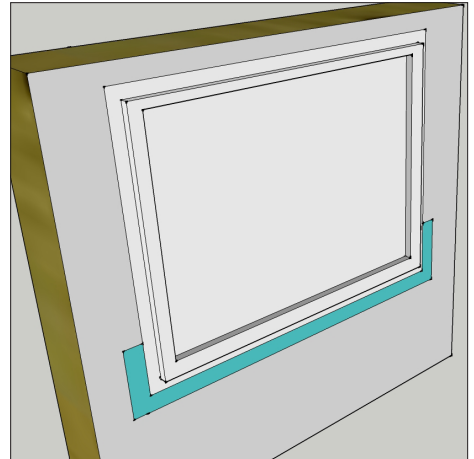

Apply a flexible sealant to the top and sides. **DO NOT SEAL** the bottom flange. Install the window.

4a Code-compliant

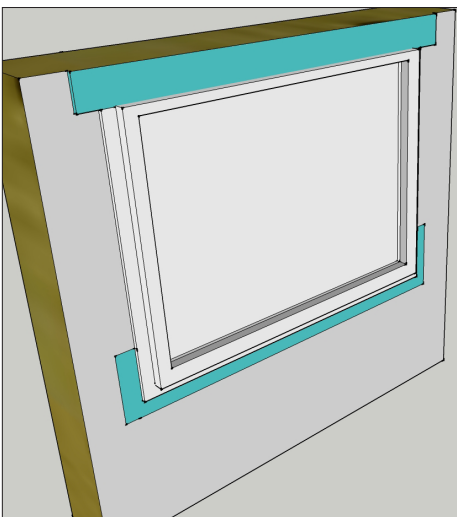

Adhere a layer of flashing membrane over the top of the window, covering the fasteners.

4b Best practice

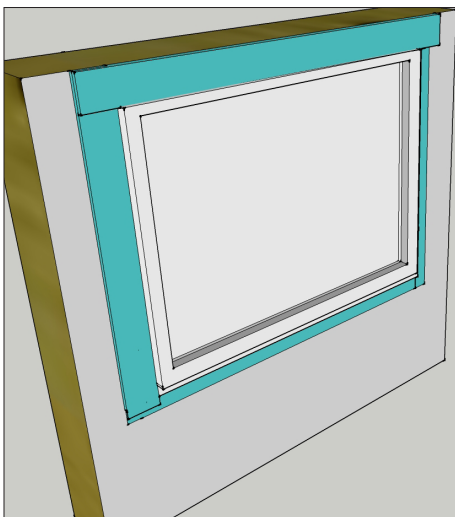

Adhere flashing membrane to both sides, covering all fasteners. Then adhere a layer of membrane over the top.

Final steps: Fold down the top layer of housewrap over the top of the window and tape housewrap in place.

When sealing with foam, be careful to allow an air gap under the bottom, to allow for condensation drain out.

**DO NOT** seal the bottom flange with either caulking, sealant, or membrane.

Sheathing tape must **NOT** be used for flashing elements. Sheathing tape may be used to tape the top layer of housewrap over the top flashing element.



SOUTHWEST NEW BRUNSWICK SERVICE COMMISSION

Planning Office : 33 Wall Street

St. Stephen NB E3L 2L5

Telephone: (506) 466-7369; email: [permits@snbs.ca](mailto:permits@snbs.ca) web: [snbsc-planning.com](http://snbsc-planning.com)